

BANKS

BRAVES



Kelly Field – 365

FUNDRAISING CAMPAIGN





Embracing the Vision of “THE BRAVE EXPERIENCE”

At the heart of the Banks School District lies a vision that transcends the ordinary, aiming to imbue every student, family, and community member with a sense of happiness and pride. This vision, known as “The Brave Experience,” is a testament to our collective aspirations for excellence in every aspect of our involvement with the Banks School District.

A pivotal step towards the full realization of this experience is the transformation of Kelly Field into a state-of-the-art athletic facility, available for use 365 days a year by both our student athletes and the wider community. The importance of sporting activities for our youth runs deep in Banks. Participation instills self-confidence, leadership skills, and team building.

This ambitious project, dubbed **Kelly Field - 365**, encompasses the replacement of the natural grass field with high-quality artificial turf and the modernization of the aging grandstand, setting a new standard for athletic and community engagement. The time for action is now!



UNDERSTANDING THE CHALLENGES

The Field: A Litany of Constraints



- **Weather Dependent Playability:** The natural grass field becomes unplayable with the onset of fall rains, affecting availability from November through April.
- **Limited Access for Sports:** To preserve the field, usage is restricted, pushing activities to alternate locations and limiting opportunities for our students.
- **Inadequate Drainage and Safety Concerns:** Poor drainage and less-than-optimal playing conditions have led to injuries, a situation that is untenable and contrary to our values.
- **Insufficient Field Size and Infrastructure:** The field does not meet soccer width requirements, and essential facilities like the long jump and lighting need relocation for optimal use.
- **Increasing Demand:** With over 700 players across various sports and physical education, the pressure on Kelly Field has never been greater, underscoring the urgent need for expansion and improvement.

The Grandstand: Time for Renewal

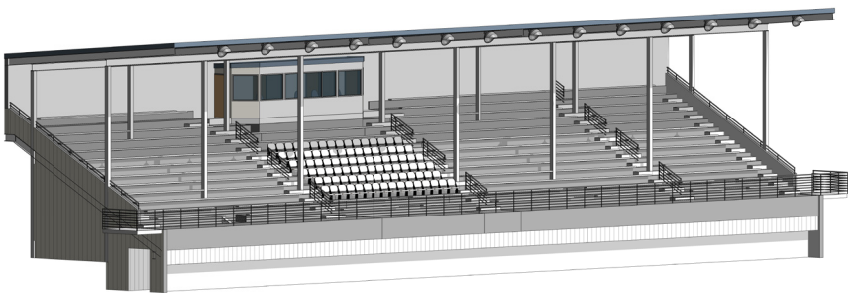

VIEW 1

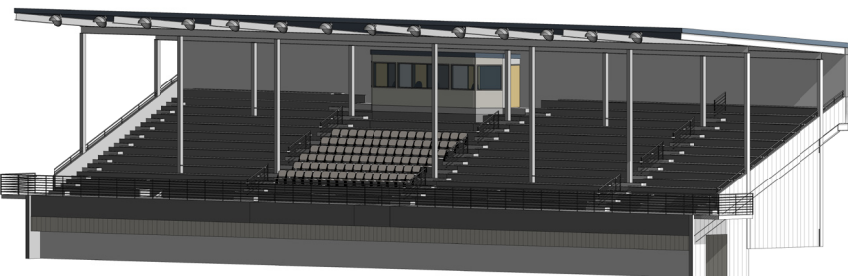

VIEW 2

- **Accessibility and Safety Issues:** Challenges such as ADA compliance, unsafe stairs, and obstructed views highlight the urgent need for a new grandstand.
- **Maintenance and Functionality:** Escalating maintenance costs and the annual need to replace deteriorating parts of the all-wood structure signal the end of its useful life.

OUR PLAN: A Vision in Action

Phase 1: Reinventing the Field

The initial phase will introduce a new turf football/soccer/lacrosse field, addressing the long-standing issues of playability and safety. This includes relocating the long jump pits to the north end zone, upgrading and moving field lighting outside of the track, and centering the new turf field inside the new track allowing for full width soccer. This sets the stage for a truly year-round facility.

Phase 2: A New Grandstand for a New Era

The construction of a new grandstand will usher in a host of improvements, from enhanced spectator accessibility, including covered ADA seating, to modern amenities such as a larger press box and upgraded reserved seating. Also included are safety features such as proper stairways and railings. The project will be completed by relocating a new larger concession stand to the sports plaza, embodying our commitment to excellence and community pride.



WHY NOW? Seizing the Moment

With the recent completion of a new track, the momentum is with us to upgrade our facilities to match. After two decades of battling the limitations of our aging infrastructure, the time is ripe for a transformative change that aligns with our sports-loving community's aspirations.

THE COSTS: Investing in Our Future

The total project cost stands at \$5,900,000, with Phase 1 (field upgrades) requiring \$2,200,000 and Phase 2 (grandstand/concessions upgrades) the remaining \$3,700,000. Included is the establishment of an annual maintenance fund for the field and grandstand. This investment will be sourced from private donations and foundation grants, with construction commencing as soon as funding for Phase 1 is secured. This capital campaign is a call to action for all who share in the vision of *Kelly Field - 365*, a beacon of pride and community spirit.

THE BRAVE EXPERIENCE: A Call to Commitment

Kelly Field - 365 is not just an infrastructure project; it is a commitment to the heart and soul of our community. It represents a tangible expression of “The Brave Experience,” where quality facilities are not just a backdrop but a central player in our shared journey towards excellence. Let us unite in making *Kelly Field - 365* a reality, for the benefit of our students, our families, and our future.



JOIN US

We invite you to be part of this historic undertaking. Your support, whether through donations, advocacy, or volunteerism, is crucial to transforming Kelly Field into a symbol of our community's aspirations and achievements. This project is not just for school age families but for all of us. It will provide facilities for use by the entire community, enhance overall community value, and create a great fan experience for all sports. Together, we can create a legacy that will inspire pride and joy in the Banks School District for generations to come.





Let's make Kelly Field – 365 a
cornerstone of "The Brave Experience."

Join us in this journey towards a
brighter, more inclusive future for all.

BANKS



*Extensive technical support for this project has been provided by
Five Star Builders and Vandermac Architecture.*